

# FS-ABYS insert compatible with Abyss®, incl. Leviathan® and Kraken® expansions

## Assembly Instructions

The package contains 4 sheets, two of them are identical to the other two.

The parts marked in sheet A2 are to be discarded.

After assembly the trays are put in three layers in the original game box.

Ordinary PVA glue is required when assembling each tray.

Please make sure you dry-assemble each tray correctly before gluing it together.

Please check [www.foldedspace.net](http://www.foldedspace.net) for general assembly tips.

## FS-ABYS

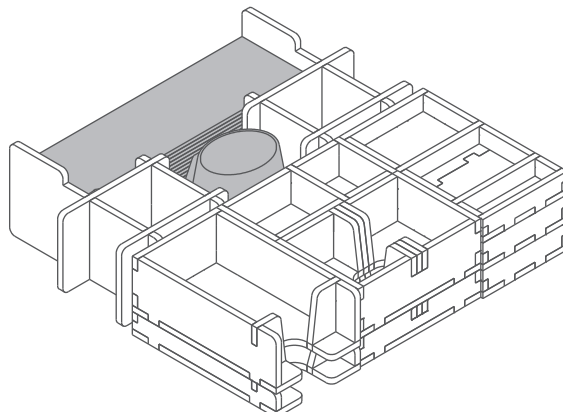

Sheet A1

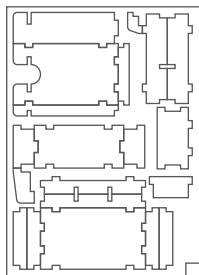

Sheet A2

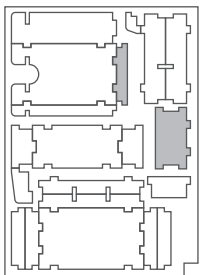

Sheet B1

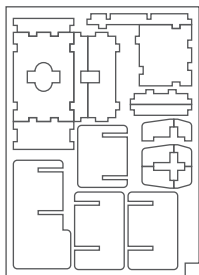

Sheet B2

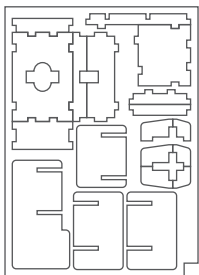

### Tray 1a

Sheet A1

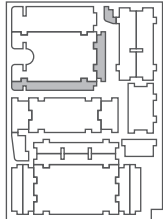

Sheet A2

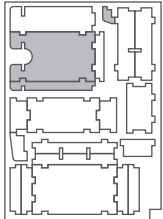

Step 1

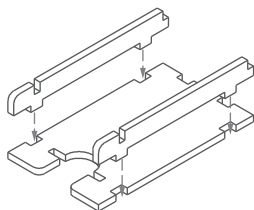

Step 2

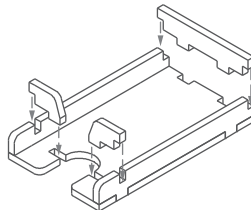

Finished tray

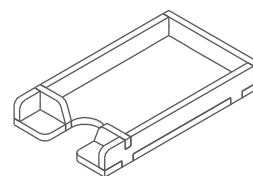

### Tray 1b

Sheet A1

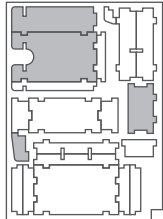

Sheet A2

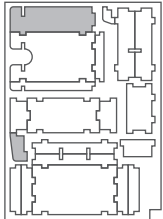

Step 1

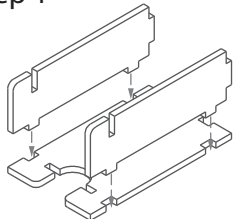

Step 2

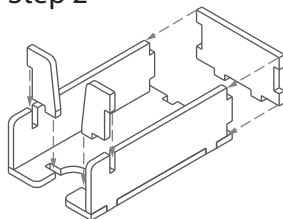

Finished tray

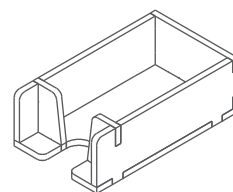

### Tray 2a & 2b (the trays are identical)

Sheet A1

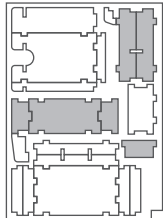

Sheet A2

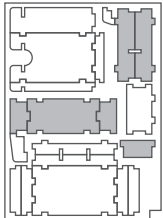

Step 1

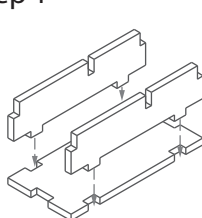

Step 2

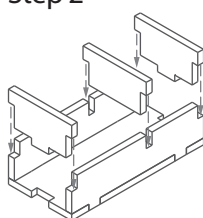

Finished tray

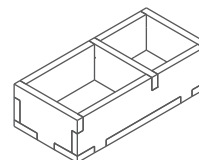

### Tray 3a & 3b (the trays are identical)

Sheet A1

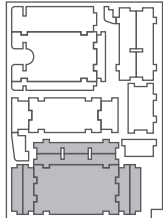

Sheet A2

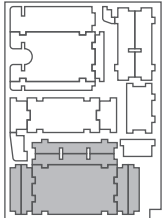

Step 1

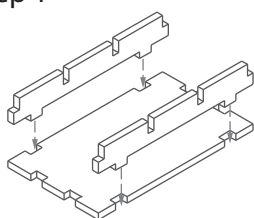

Step 2

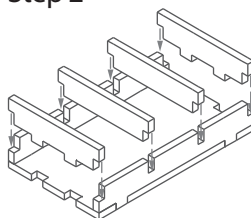

Finished tray

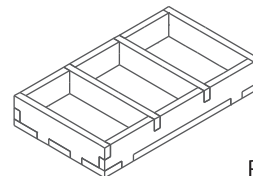

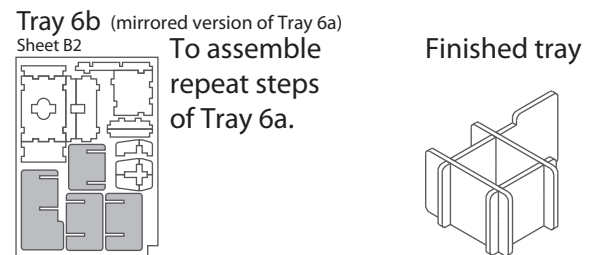
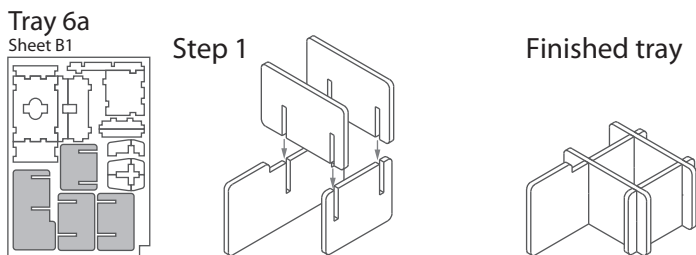
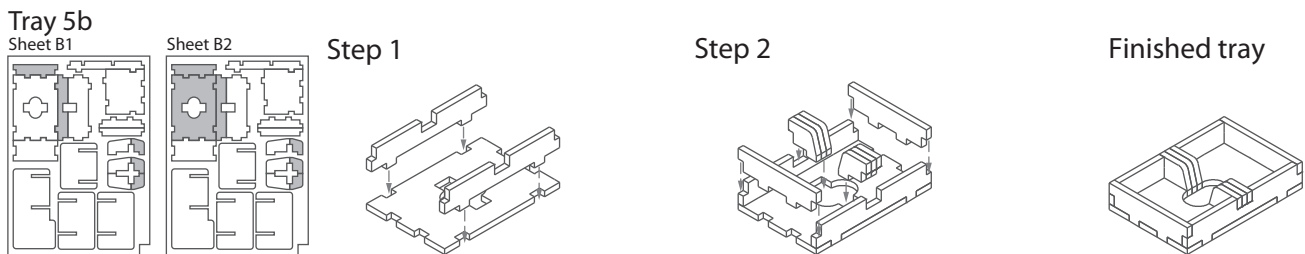
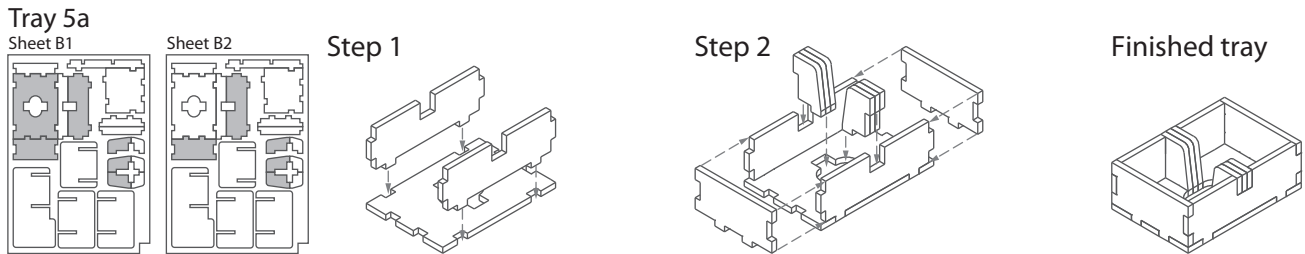
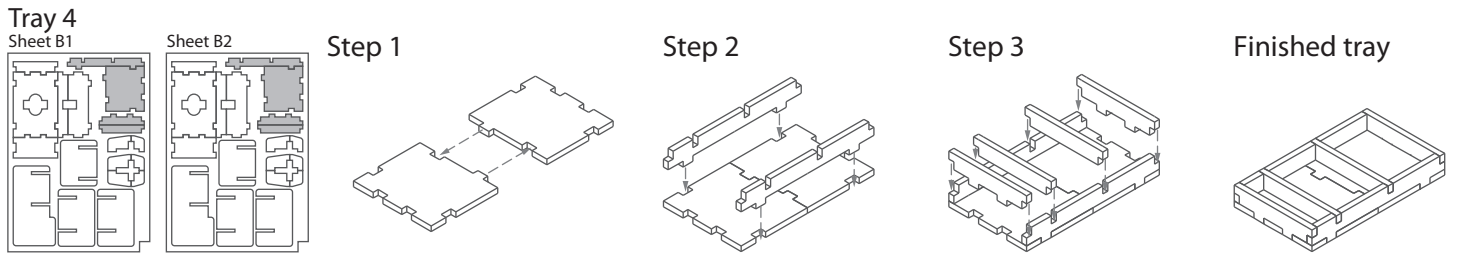

## FS-ABYS

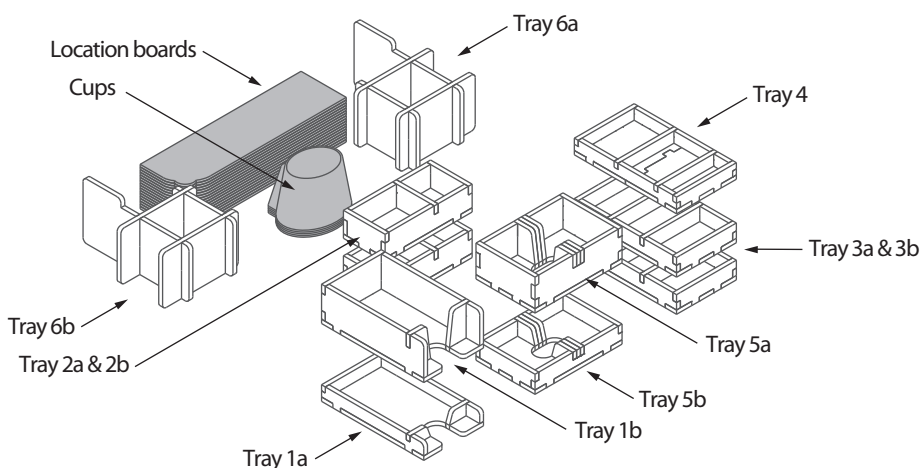

Please check [www.foldedspace.net](http://www.foldedspace.net) for photos of this insert in use.

### Tray legend:

- Tray 1a - leviathan cards
- Tray 1b - lord cards
- Tray 2a - light and black pearls
- Tray 2b - dice and other tokens
- Tray 3a, b - monster tokens
- Tray 4 - wound, key and threat tokens
- Tray 5a - exploration cards
- Tray 5b - loot cards
- Tray 6a, b - filler trays, with miniatures in middle slot

Note: the score pad is placed on top of the plastic cups stack.